

Metric Induction Hardened Gears

20° Pressure Angle

DIN 782

Material: Steel 1.0503 (C45) AISI 1045

Standard Wide Face

Spur Gears

Part No.	Module	Teeth	Tooth Face F	Width W	Outside Ø de	Pitch Ø dp	Hub Ø dm	Bore Ø D1 ±1 mm	Weight kg
HTM1B15	1	15	15	25	17.0	15.0	12	5	0.016
HTM1B20	1	20	15	25	22.0	20.0	16	6	0.027
HTM1B25	1	25	15	25	27.0	25.0	20	6	0.045
HTM1B30	1	30	15	25	32.0	30.0	20	8	0.059
HTM1B40	1	40	15	25	42.0	40.0	25	8	0.108
HTM1B60	1	60	15	25	62.0	60.0	40	10	0.260
HTM1.5B15	1.5	15	17	30	25.5	22.5	18	6	0.057
HTM1.5B20	1.5	20	17	30	33.0	30.0	25	8	0.097
HTM1.5B25	1.5	25	17	30	40.5	37.5	25	8	0.142
HTM1.5B30	1.5	30	17	30	48.0	45.0	30	10	0.195
HTM1.5B40	1.5	40	17	30	63.0	60.0	40	10	0.355
HTM1.5B60	1.5	60	17	30	93.0	90.0	60	12	0.815
HTM2B15	2	15	20	35	34.0	30.0	24	8	0.118
HTM2B20	2	20	20	35	44.0	40.0	30	10	0.195
HTM2B25	2	25	20	35	54.0	50.0	35	10	0.285
HTM2B30	2	30	20	35	64.0	60.0	40	12	0.448
HTM2B40	2	40	20	35	84.0	80.0	50	12	0.760
HTM2B60	2	60	20	35	124.0	120.0	70	15	1.910
HTM2.5B15	2.5	15	25	45	42.5	37.5	30	10	0.200
HTM2.5B20	2.5	20	25	45	55.0	50.0	40	12	0.340
HTM2.5B25	2.5	25	25	45	67.5	62.5	50	12	0.550
HTM2.5B30	2.5	30	25	45	80.0	75.0	55	15	0.860
HTM2.5B40	2.5	40	25	45	105.0	100.0	70	15	1.500
HTM2.5B60	2.5	60	25	45	155.0	150.0	100	20	3.410
HTM3B15	3	15	30	50	51.0	45.0	35	12	0.375
HTM3B20	3	20	30	50	66.0	60.0	45	15	0.600
HTM3B25	3	25	30	50	81.0	75.0	60	15	0.955
HTM3B30	3	30	30	50	96.0	90.0	60	20	1.450
HTM3B40	3	40	30	50	126.0	120.0	80	20	2.680
HTM3A60	3	60	30	-	186.0	180.0	-	25	4.840
HTM4B15	4	15	40	60	68.0	60.0	45	15	0.796
HTM4B20	4	20	40	60	88.0	80.0	60	20	1.383
HTM4B25	4	25	40	60	108.0	100.0	75	20	2.220
HTM4B30	4	30	40	60	128.0	120.0	75	25	3.290
HTM4A40	4	40	40	-	168.0	160.0	-	25	4.920
HTM4A60	4	60	40	-	248.0	240.0	-	30	11.060
HTM5B15	5	15	50	75	85.0	75.0	60	20	1.50
HTM5B20	5	20	50	75	110.0	100.0	80	25	2.61
HTM5B25	5	25	50	75	135.0	125.0	90	25	4.30
HTM5A30	5	30	50	-	160.0	150.0	-	30	5.25
HTM5A40	5	40	50	-	210.0	200.0	-	30	9.58
HTM5A60	5	60	50	-	310.0	300.0	-	40	21.60
						90.0	-	25	2.56
HTM6B15	6	15	50	75	102.0	-	-	-	-
HTM6B20	6	20	50	75	132.0	120.0	70	25	4.60
HTM6B25	6	25	50	75	162.0	150.0	90	30	7.02
HTM6A30	6	30	50	-	192.0	180.0	-	30	9.23
HTM6A40	6	40	50	-	252.0	240.0	-	30	16.61
HTM6A60	6	60	50	-	372.0	360.0	-	40	37.70
HTM8B15	8	15	64	95	136.0	120.0	80	25	7.24
HTM8B20	8	20	64	95	176.0	160.0	100	30	12.80
HTM8B25	8	25	64	95	216.0	200.0	125	30	21.50
HTM8A30	8	30	64	-	256.0	240.0	-	30	39.00
HTM8A40	8	40	64	-	336.0	320.0	-	40	52.50
HTM8A60	8	60	64	-	496.0	480.0	-	50	72.50

Note: "A" type gears with out hub

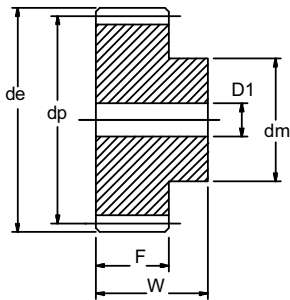

Metric Induction Hardened Gears

20° Pressure Angle

DIN 782

Material: Steel 1.0503 (C45) AISI 1045

Special Narrow Face

Spur Gears

Part No.	Module	Teeth	Tooth Face F	Width W	Outside Ø de	Pitch Ø dp	Hub Ø dm	Bore Ø D1 ±1 mm	Weight kg
HTM1B15F8	1	15	8	18	17.0	15.0	12	5	0.016
HTM1B20F8	1	20	8	18	22.0	20.0	15	6	0.027
HTM1B25F8	1	25	8	18	27.0	25.0	18	6	0.045
HTM1B30F8	1	30	8	18	32.0	30.0	20	8	0.059
HTM1B40F8	1	40	8	18	42.0	40.0	25	8	0.108
HTM1B60F8	1	60	8	18	62.0	60.0	40	10	0.260
HTM1.5B15F12	1.5	15	12	25	25.5	22.5	18	6	0.057
HTM1.5B20F12	1.5	20	12	25	33.0	30.0	20	8	0.097
HTM1.5B25F12	1.5	25	12	25	40.5	37.5	25	8	0.142
HTM1.5B30F12	1.5	30	12	25	48.0	45.0	30	10	0.195
HTM1.5B40F12	1.5	40	12	25	63.0	60.0	40	10	0.355
HTM1.5B60F12	1.5	60	12	25	93.0	90.0	60	12	0.815
HTM2B15F16	2	15	16	30	34.0	30.0	24	8	0.118
HTM2B20F16	2	20	16	30	44.0	40.0	28	10	0.195
HTM2B25F16	2	25	16	30	54.0	50.0	30	10	0.285
HTM2B30F16	2	30	16	30	64.0	60.0	40	12	0.448
HTM2B40F16	2	40	16	30	84.0	80.0	50	12	0.760
HTM2B60F16	2	60	16	30	124.0	120.0	80	15	1.910
HTM2.5B15F20	2.5	15	20	35	42.5	37.5	25	10	0.200
HTM2.5B20F20	2.5	20	20	35	55.0	50.0	30	12	0.340
HTM2.5B25F20	2.5	25	20	35	67.5	62.5	40	12	0.550
HTM2.5B30F20	2.5	30	20	35	80.0	75.0	50	15	0.860
HTM2.5B40F20	2.5	40	20	35	105.0	100.0	60	15	1.500
HTM2.5B60F20	2.5	60	20	35	155.0	150.0	90	20	3.410
HTM3B15F25	3	15	25	40	51.0	45.0	30	12	0.375
HTM3B20F25	3	20	25	40	66.0	60.0	40	15	0.600
HTM3B25F25	3	25	25	40	81.0	75.0	50	15	0.955
HTM3B30F25	3	30	25	40	96.0	90.0	60	20	1.450
HTM3B40F25	3	40	25	40	126.0	120.0	80	20	2.680
HTM3A60F25	3	60	25	-	186.0	180.0	-	25	4.840
HTM4B15F32	4	15	32	50	68.0	60.0	45	15	0.796
HTM4B20F32	4	20	32	50	88.0	80.0	50	20	1.383
HTM4B25F32	4	25	32	50	108.0	100.0	60	20	2.220
HTM4B30F32	4	30	32	50	128.0	120.0	80	25	3.290
HTM4A40F32	4	40	32	-	168.0	160.0	-	25	4.920
HTM4A60F32	4	60	32	-	248.0	240.0	-	30	11.060
HTM5B15F40	5	15	40	60	85.0	75.0	50	20	1.50
HTM5B20F40	5	20	40	60	110.0	100.0	70	25	2.61
HTM5B25F40	5	25	40	60	135.0	125.0	80	25	4.30
HTM5A30F40	5	30	40	-	160.0	150.0	-	30	5.25
HTM5A40F40	5	40	40	-	210.0	200.0	-	30	9.58
HTM5A60F40	5	60	40	-	310.0	300.0	-	40	21.60
HTM6B15F48	6	15	48	70	102.0	90.0	60	25	2.56
HTM6B20F48	6	20	48	70	132.0	120.0	70	25	4.60
HTM6B25F48	6	25	48	70	162.0	150.0	80	30	7.02
HTM6A30F48	6	30	48	-	192.0	180.0	-	30	9.23
HTM6A40F48	6	40	48	-	252.0	240.0	-	30	16.61
HTM6A60F48	6	60	48	-	372.0	360.0	-	40	37.70
HTM8B15F64	8	15	64	95	136.0	120.0	80	25	7.24
HTM8B20F64	8	20	64	95	176.0	160.0	100	30	12.80
HTM8B25F64	8	25	64	95	216.0	200.0	125	30	21.50
HTM8A30F64	8	30	64	-	256.0	240.0	-	30	39.00
HTM8A40F64	8	40	64	-	336.0	320.0	-	40	52.50
HTM8A60F64	8	60	64	-	496.0	480.0	-	50	72.50

Note: "A" type gears with out hub Part No. Example: HTM3B15F25

HT = Hardened Teeth 15 = Teeth
M3 = 3 Module F25 = 25mm Tooth Face
B = with HVB

